

PIANTA

Scala 1:50

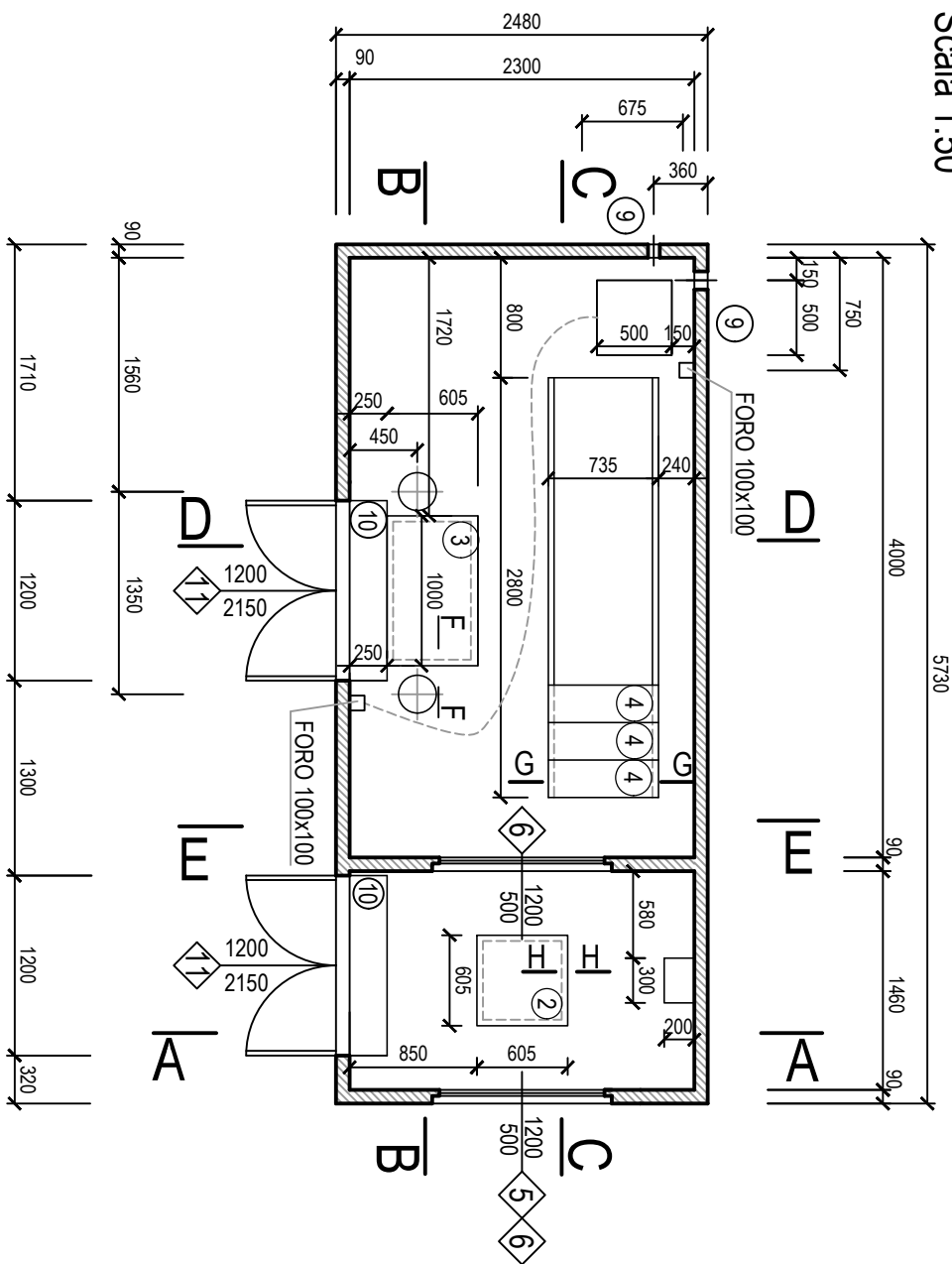

- LEGENDA:**
- ② PLOTTA ISPEZIONE VTR 600x600 mm.
 - ③ PLOTTA ISPEZIONE VTR 600x1000 mm.
 - ④ LASTRE IN VETRORESINA SP. 40 mm.
 - ⑨ PASSACAVO ANTENNA
 - ⑩ SCIVOLO INGRESSO
 - ⑤ GRIGLIA VTR ALTA (1200x500)
 - ⑥ GRIGLIA VTR BASSA (1200x500)
 - ⑪ PORTA VTR 2 ANTE (1200x2150)

② PLOTTA IN VETRORESINA SP.40
PER COPERTURA ACCESSO IN VASCA

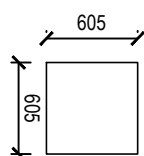

SEZIONE H-H
Scala 1:25

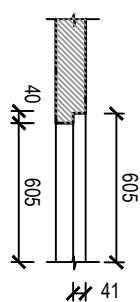

③ PLOTTA IN VETRORESINA SP.40
PER COPERTURA ACCESSO IN VASCA

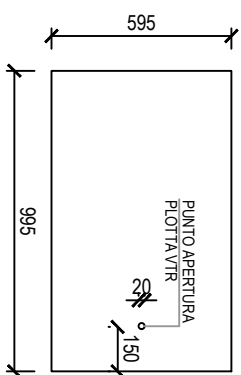

SEZIONE F-F
Scala 1:25

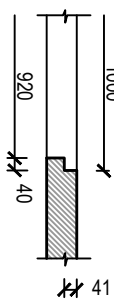

④ LASTRE IN VETRORESINA SP.40
PER COPERTURA FORI MT (N°6 PEZZI)

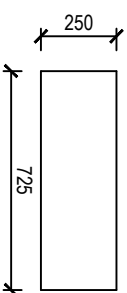

SEZIONE G-G
Scala 1:25

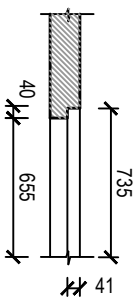

edilceem s.r.l.

Via Senatore Fabbri, 18 - 31027 Lovadina (TV)
Tel 0422 725109 / 0422 722180 Fax 0422 881891
e-mail: info@edilceem.it
www.edilceem.it

Oggetto: **CABINA ELETTRICA PREFABBRICATA
ENEL DG2061 ED. 09
BOX CLIENTE RIDOTTO**

Tavola: **PROGETTO ARCHITETTONICO
PIANTA**

Scheda: **DG2061_9CR**

Codice disegno: **E20619CR.01**

File:

Foglio: 1 / 3

Scala:

Rev 1: A

Rev 2:

Disegnato:

Approvato:

Data: .. / .. / ..

Data: .. / .. / ..

28/10/2021

.....

PROSPETTO LATERALE DX

Scala 1:50

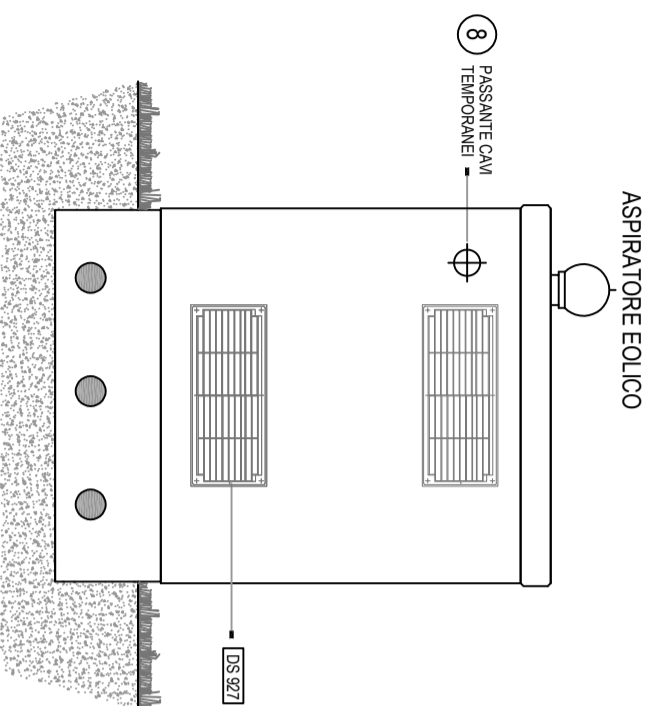

PROSPETTO LATERALE SX

Scala 1:50

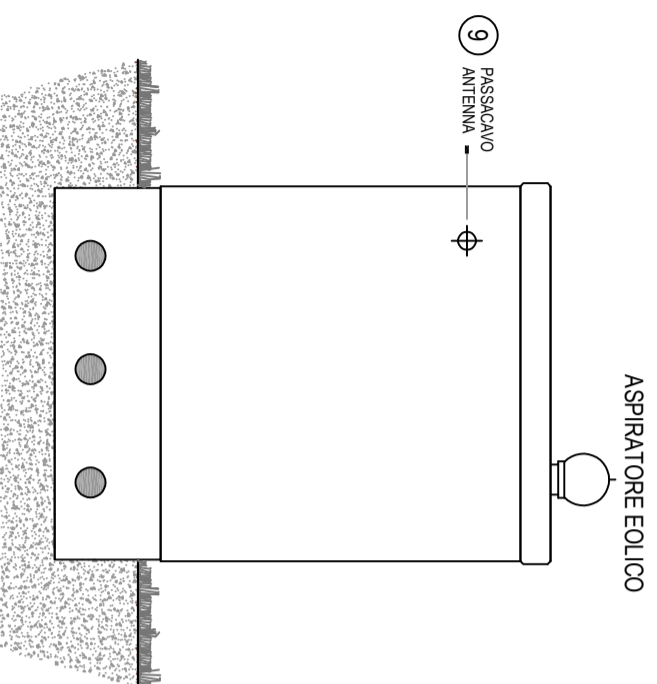

PROSPETTO FRONTALE

Scala 1:50

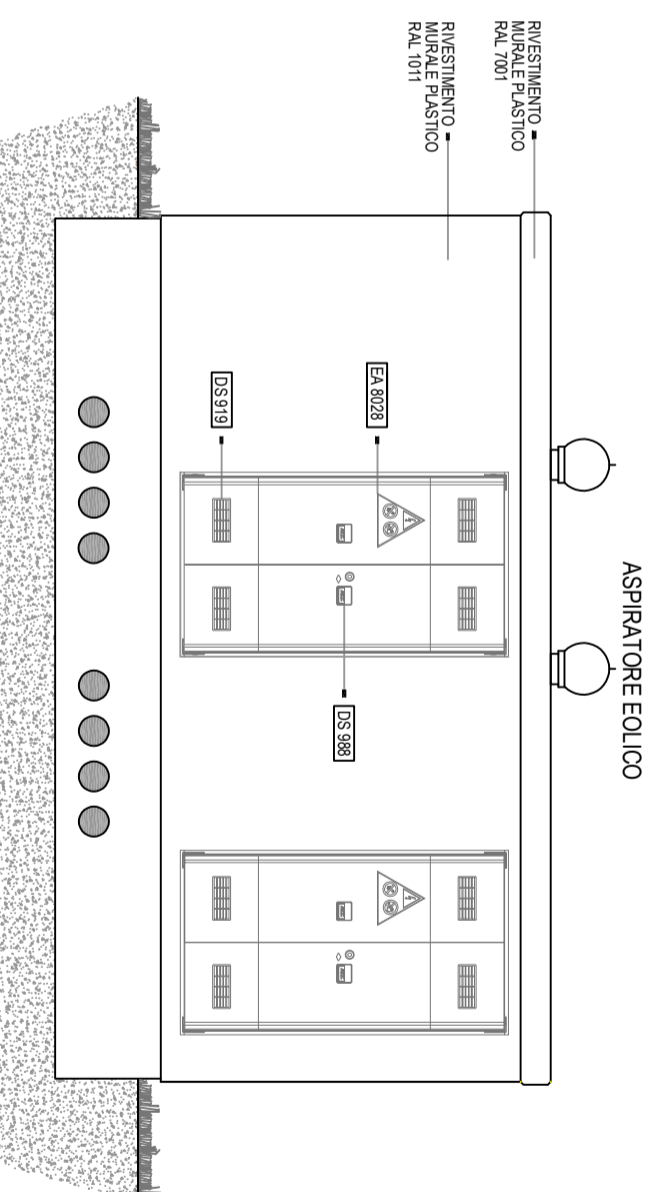

PROSPETTO POSTERIORE

Scala 1:50

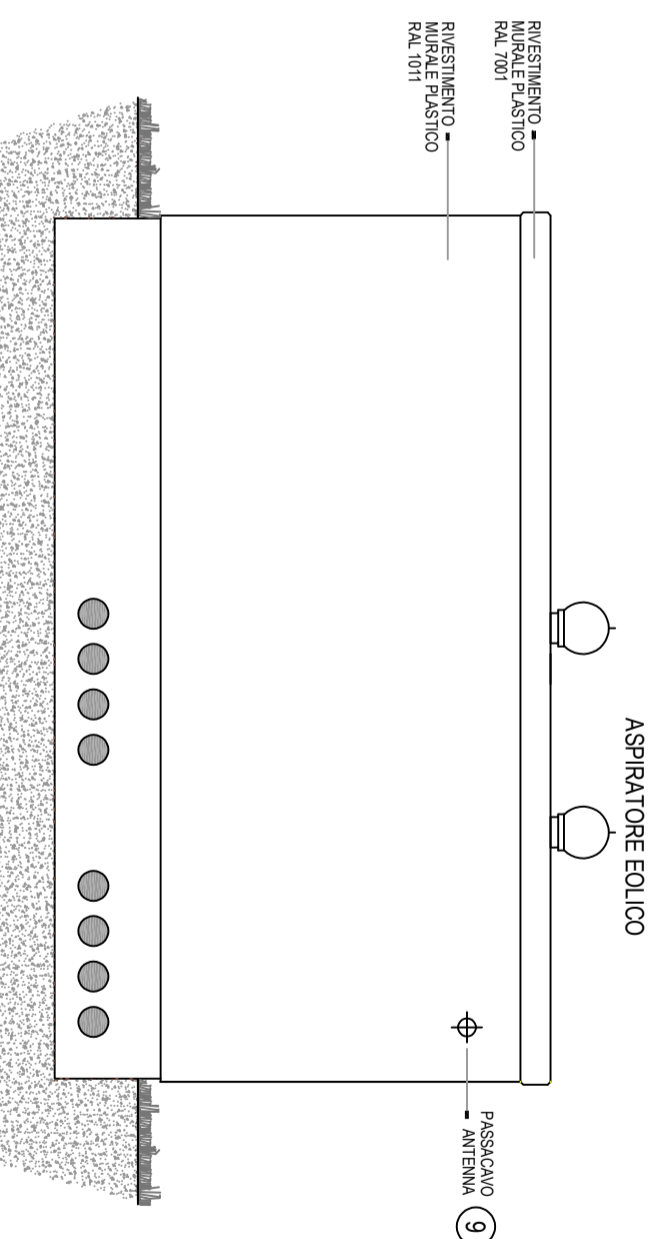

edilceem s.r.l.
 Via Senatore Fabbri, 18 - 31027 Lovadina (TV)
 Tel 0422 725109 / 0422 722180 Fax 0422 881891
 e-mail: info@edilceem.it
 www.edilceem.it

Oggetto: **CABINA ELETTRICA PREFABBRICATA ENEL DG2061 ED. 09 BOX CLIENTE RIDOTTO**

Tavola: **PROGETTO ARCHITETTONICO PROSPETTI**

Scheda: DG2061_9CR	Rev 1: A	Data: .. / .. / ..
Codice disegno: E20619CR.01	Rev 2:	Data: .. / .. / ..
File:	Disegnato: 28/10/2021	
Foglio: 2 / 3	Scala:	Approvato:

SEZIONE A-A

Scala 1:50

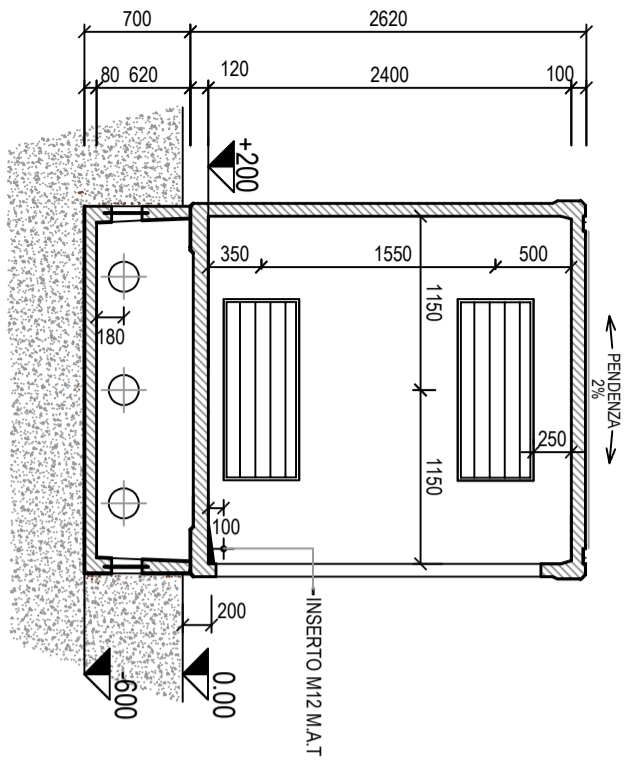

SEZIONE E-E

Scala 1:50

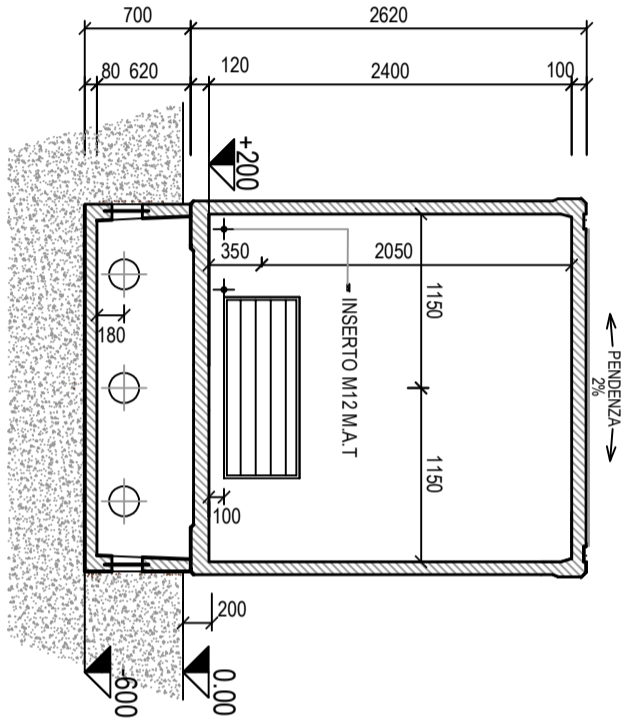

SEZIONE B-B

Scala 1:50

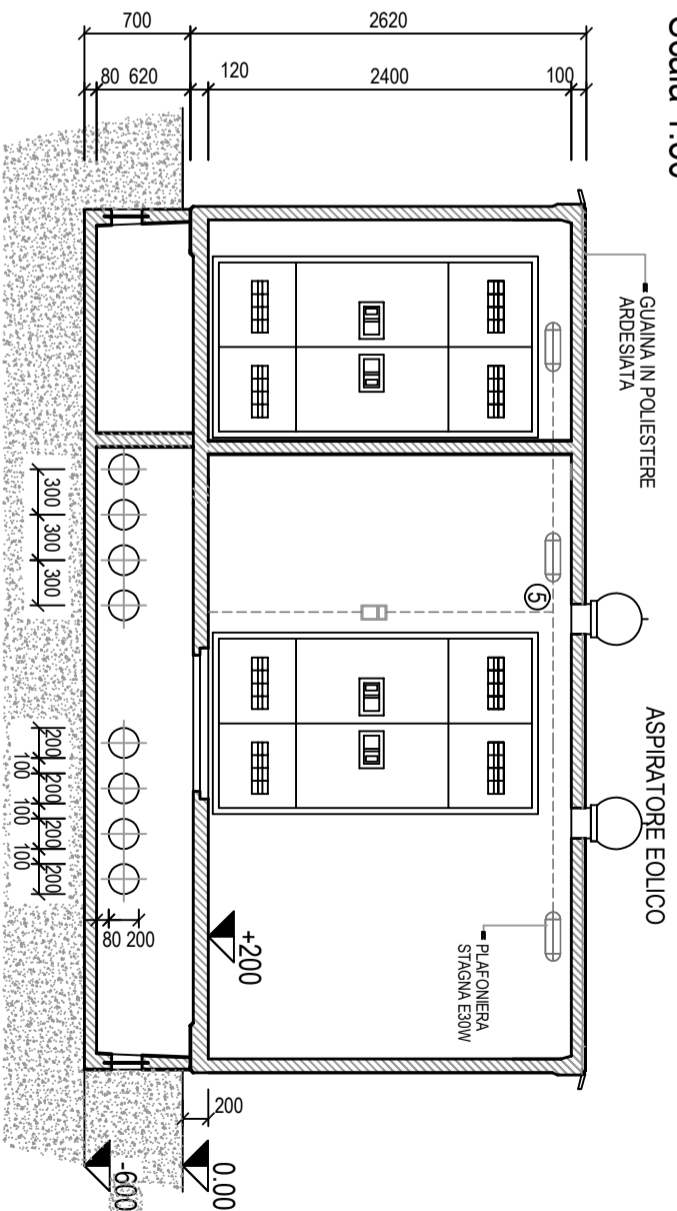

SEZIONE D-D

Scala 1:50
ASPIRATORE EOLICO

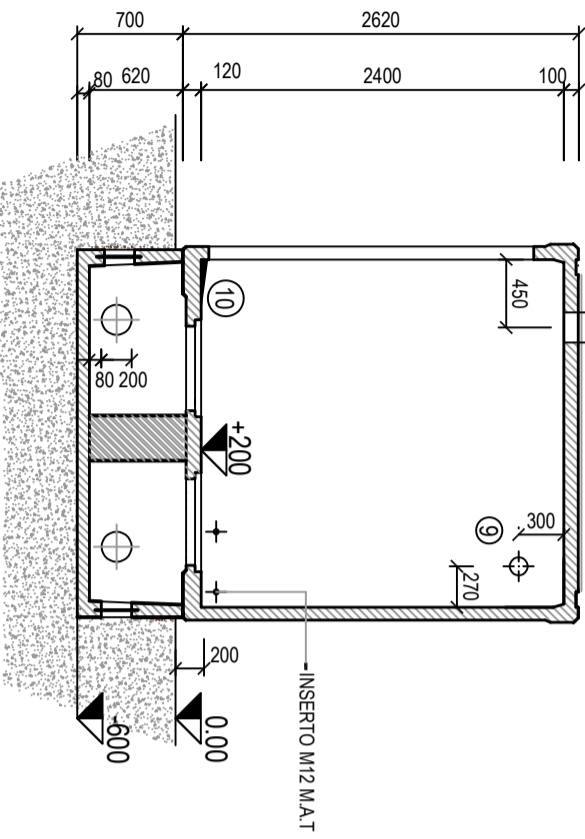

SEZIONE C-C

Scala 1:50

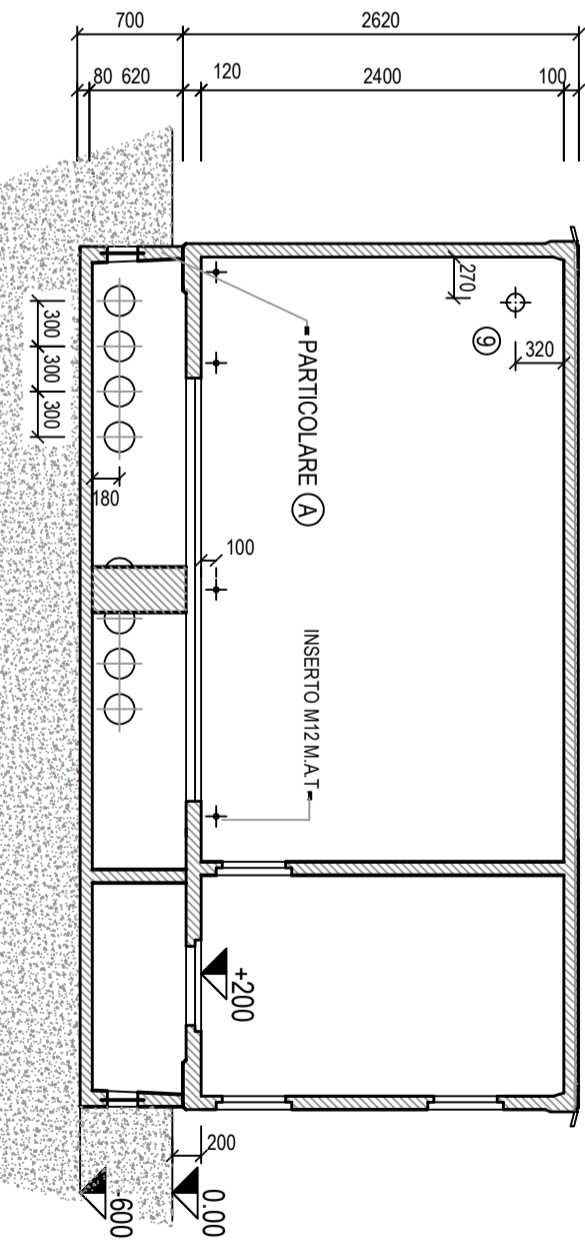

edilceem s.r.l.

Via Senatore Fabbri, 18 - 31027 Lovadina (TV)
Tel 0422 725109 / 0422 722180 Fax 0422 881891
e-mail: info@edilceem.it
www.edilceem.it

Oggetto: **CABINA ELETTRICA PREFABBRICATA
ENEL DG2061 ED. 09
BOX CLIENTE RIDOTTO**

Tavola: **PROGETTO ARCHITETTONICO
SEZIONI**

Scheda: **DG2061_9CR**

Codice disegno: **E20619CR.01**

File:

Foglio: 3 / 3

Scala:

Rev 1: A

Rev 2:

Disegnato: 28/10/2021

Approvato:

Data: .. / .. / ..

Data: .. / .. / ..